



USER MANUAL

ZO02 ELECTRIC SCOOTER



Please read this manual carefully before using.

Contents

STEM INSTALLATION	-----	1
HANDLE BAR INSTALLATION	-----	2
FRONT WHEEL INSTALLATION	-----	3
FRONT LIGHT & FENDER INSTALLATION	-----	4
SPECIFICATION	-----	5
CHARGING TIPS	-----	6
SAFETY INSTRUCTIONS	-----	7
STORAGE AND CLEANING	-----	8
WARRANTY	-----	9
WARRANTY CARDS	-----	11
CONTACT US	-----	12

STEM INSTALLATION

1.



Hold the scooter frame and push up the folding stem to open it up.

2.



Adjust the position of stem and handlebar properly

3.



Close the buckle at the fold to fix the stem with your right hand

4.



Finally turn the plastic ring on the stem to lock the buckle.

HANDLEBAR INSTALLATION



Loosen the quick release lever on the head of the stem



Lift the handlebar upward and height, then close the quick release lever



Lift the quick release lever on the handlebar, turn the handlebar to adjust the brake lever to the right position



Finally, close the quick release lever on the handlebar to lock the handle bar.

FRONT WHEEL INSTALLATION



Loosen the nut of quick release lever, leaving a spring on the head



Insert into the hub from left to right, the quick release head is on the side without disc brake pads

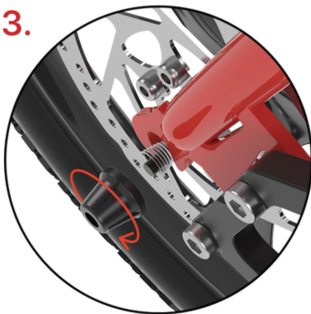

At the other end, put the spring first, the diameter inside small and the outside is large, and then put a nut



After adjusting both sides, close the quick release lever to lock

FRONT LIGHT & FENDER INSTALLATION



Align the headlight bracket and the fender on the top of the front fork.



Insert the bolt and a washer into the headlight bracket, put the bolt through the hole in the fork.



Put the fender bracket on the other end of the bolt.



Put nuts and washers and tighten

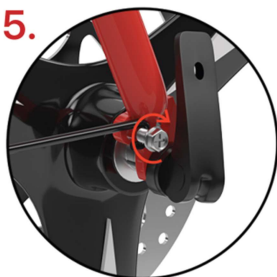

Fix the brackets on both sides of the fender and screw them tightly.



Adjust the clamp on the fender to make fender and brackets in right position.

SPECIFICATION

Item	Specification
Motor	36V/350W high torque DC
Battery	36V10Ah
Max speed	25KM/H
Range	Around 30km
Brake	Full disk brake
Tire size	Front 20inch and Rear 16 inch
Climbing	25 degree
Product Size	1550*45*1030-1250mm
Packing Size	1405*235*585mm
Weight	15/17.5kg
Support	150kg
Charging Time	5~7 hours
Material	Aluminum alloy
Color	Grey/Yellow/Others

CHARGING TIPS

- Charge at least 5 hours before the first operation.
- To maximize the battery life, please charge once per month or after two days of riding. Please charge at the suitable temperature.
- Not charge on time may cause battery damage. The battery power will be totally out and dead without charging for long time.
- Please use the batteries, chargers and cables supplied by the original manufacturer and prevent the battery from being over-charged.
- Please ensure that the charger cables are connected correctly at ventilated environment.
- Please make sure you use it in a dry environment. Chargers or cables will never be allowed to touch water because it could lead to electric shocks. Do not touch with wet hands. If any failure occurs during charging, unplug immediately
- Do not allow the charger or cable to contact the sharp or hot items.
- Do not touch the metal contacts on the charger socket with hand or metal that may cause short-circuit in case of accidents.
- Do NOT place inflammable under the charger because heat is generated while it is working. It is prohibited that the charger is covered or surrounded by anything so as not to affect heat dissipation.
- If the charger cable has obvious damage. Do not use charger to avoid further damage, please contact for replacement.
- Please do not repair the battery, charger or cable independently.

SAFETY INSTRUCTIONS

ZO02 electric scooter is a personal mobility tool with a certain speed.

Technology and production are strictly tested. If you don't ride it according to the terms in this manual, it may bring you riding risk. Please pay attention the terms as below:

- Wear a helmet and protective gear while riding.
- Check whether the folding mechanism has been locked up
- Check whether the braking system works flexibly and make sure that the power is cut off when braking.
- We don't recommend ride to the slope which is more than 30°, and do not speed up or slow down suddenly on the slope.
- Pay attention to obstacles and slippery roads; Don't ride on the grass or crushed stone road.
- Do not ride in the water exceed 30mm in depth.
- It is forbidden to ride up and down the stairs.
- It is forbidden to ride on road way.
- It is forbidden to soak the scooter in water.
- Anyone who is less than 18 years old or older than 55 needs to be assisted when riding.
- Please make sure the electricity is full and the tire is normal before riding.
- Don't try to speed fast before you are familiar with riding . Please speed up slowly.
- The scooter is used only for daily travel. Do not use it as an extreme sport and similar dangerous riding.

STORAGE AND CLEANING

Storage

- Avoid storing the scooter at the direct sunlight place(even if storing in your car trunk) ,As after a period of time, the scooter body and the battery temperature will reach to more than 50 degrees, the function and the scooter battery life will be damaged .
- Avoid storing electric scooter in wet conditions.
- When the scooter is out of usage, the battery will automatically loose power. You should test the battery electricity at least once one month, and charging in time to ensure that the battery is full of power. Avoid the battery running out of power over a long time because it may cause irreparable damage (such as battery deeply losing power).
- In winter, the batteries may lose power faster because of low temperatures.
- Inappropriate storage will lead to the lithium battery life shorten or cause other hidden problems. Please store the electric scooter indoor and make sure the place is dry and the temperature,humidity is suitable.

Cleaning

- Before cleaning, make sure the scooter is turned off, unplug the charging line and cover the charging port. During the cleaning process, be careful keep the water out of charging port.
- The grade of waterproof and dust proof is IP54, which is anti-splash and anti- dust. Therefore, it is forbidden to immerse the electric scooter in water, which will cause permanent damage to the scooter

WARRANTY

Customers could enjoy free repair or replacement when the following situations occur:

- The non-artificial fault occurs in normal use during warranty period.
- The faulty caused by our company allowed disassembly, conversion, and other operations.
- There is no tear and obliteration of the S/N, tag and other signs.
- Provide efficient purchasing proof, receipt, and warranty card.

Different product warranty period (from purchase time)

S/N	Parts Description	Warranty Period
1	Frame, Motor brake, Controller	12 months
2	Battery, charger	6 months
3	Lights, throttles and some functional parts	1 months
4	Wearing parts	No warranty

Note: Damage caused by human factors is not covered by the warranty.

Exceptions

Customers could not enjoy free repair/replacement/maintenance when the following situations occur:

- The faulty of battery damage, motor damage, connector damage,

etc.caused by long time use in rain or immersion in water.

- The faulty caused by overload drive, long climbing or long driving on bumpy road, etc.
- The faulty caused by incorrect installation and operation violated the terms in the manual.
- The faulty caused by self-disassembly and unauthorized conversion.
- The faulty caused by incorrect storage. Or using in unallowed condition.
- The faulty caused by force majeure (fire, earthquake, lightning, flood damage)
- The faulty caused by incorrect invoice, warranty card, model and serial number, etc
- The faulty caused by illegal using.
- Beyond warranty period

WARRANTY CARD

WARRANTY CARD

Dear User,

Thanks for using our electric scooter. Please fill in the form below clearly for sake of better after-sale services.

User	Name		Quantity	
	Telephone			
	Address			
Date of Purchase			Motor Serial Number	
Model			VIN	
Invoice Number			Battery Serial Number	
Distributor or	Distributor Name			
	Contact			
Note				

All the necessary pictures/videos shown the products/parts problems must be provided to ZonDoo service team as well.

Your personal information and data will be 100% protected and safe.

Contact US

Please scan the below QR code for more service from ZonDoo.



ZonDoo service team: support@zond-tech.com.

Official Website: <https://www.zond-tech.com>

Please feel free to contact us should you have any query about ZonDoo products/services. We will come back to you within 24hours.

CE RoHS FC MSDS UN38.3

